

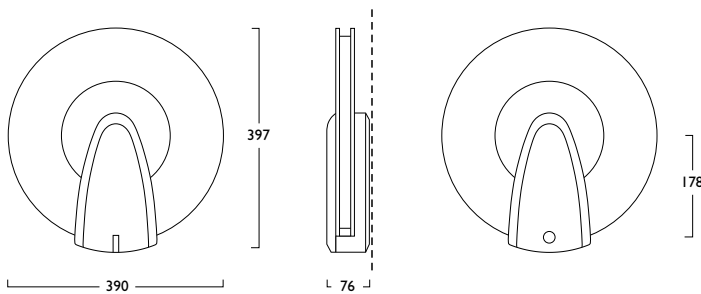

## Ascension

<b>Fluorescent</b>					
40w	TFL	2GX13	WL944	TFL040	156
55w	TFL	2GX13	WL944	TFL055	156

TFL						



Gear types F & G must be operated through a Digital Serial Interface (p389)

- D** High frequency
- E** High frequency + Emergency
- F** High frequency digital dimming
- G** High frequency digital dimming + Emergency
- H** High frequency analogue (1-10V) dimming
- I** High frequency analogue (1-10V) dimming + Emergency
- J** High frequency switch dimming
- K** High frequency switch dimming + Emergency
- S** High frequency DALI dimming
- T** High frequency DALI dimming + Emergency

1 - White 3 - Black 6 - Graphite

318	Horizontal wall mounting bracket white	157
332	Horizontal wall mounting bracket black	157
333	Horizontal wall mounting bracket graphite	157

### Current and Power Ratings

TFL Lamp	Current (A)	Power (W)
1x 40W	0.19	43.0
1x 55W	0.27	60.0

### Recommended Lamps

Type	3000K		4000K	
	Osram	Philips	Osram	Philips
TFL040	FC4083	640970	FC4084	642233
TFL055	FC5583	642790	FC5584	642516



## Ascension

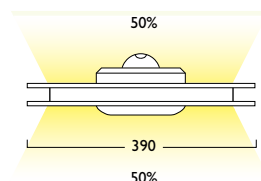
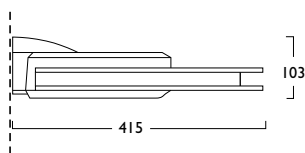
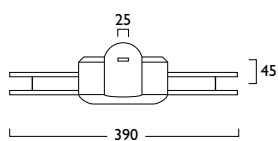

## Product Codes Explained

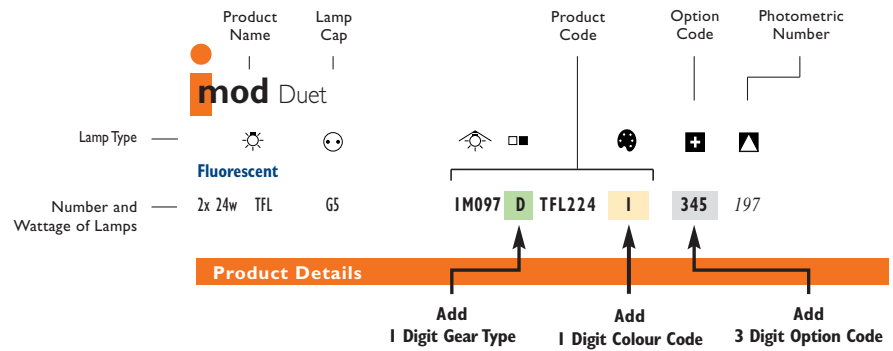

## Symbols

	12V
	Voltage & frequency
	Class I / II / III
	Ingress protection
	Suitable for flammable surface
	Plug & socket connections
	Unfused terminal block
	Fused terminal block
	Integral fuse
	Knockout size
	Tilt
	Rotation / pan
	Cut out
	Fixing centres
	<b>Uplighting</b> / Downlighting
	Uplighting / <b>Downlighting</b>
	Pressed metal construction
	Extruded aluminium construction
	Spun construction
	Die cast construction
	Injection moulding
	Minimum distance from lamp
	Decorative glass feature
	Safety glass
	Foot switch
	Supplied complete with plug
	Maximum weight kg
	Operating temperature of fascia
	Tamper proof screws
	Maximum evenly distributed load kg